



COLOR BUILDING

*Blue/white*

BUILDING RECORD

*sketch*

|                               |       |    |      |   |                          |   |   |                                 |          |               |
|-------------------------------|-------|----|------|---|--------------------------|---|---|---------------------------------|----------|---------------|
| OCCUPANCY                     |       |    |      |   | PLUMBING                 |   |   | COMMERCIAL COMPUTATIONS         |          |               |
| 1                             | 2     | 3  | 4    | 5 | NO.                      | M | O | EXTERIOR WALL CODES             |          |               |
| VAC. LOT DWELLING COMM. OTHER |       |    |      |   | STANDARD                 |   |   | 1 FRAME                         | 5 STUCCO | 9 CONCRETE    |
| BASEMENT                      |       |    |      |   | BATHROOM                 |   |   | 2 BRICK                         | 6 TILE   | 10 ENAM. STL. |
| 1                             | 2     | 3  | 4    | 5 | TOILET ROOM              |   |   | 3 GLASS                         | 7 STONE  |               |
| NONE CRAWL 1/4 1/2 FULL       |       |    |      |   | SINK/LAVATORY/SS         |   |   | 4 C B                           | 8 METAL  |               |
| FOUNDATION                    |       |    |      |   | WATER CLOSET/URINAL      |   |   | EXTERIOR WALLS                  |          |               |
| P                             | B & S | CB | CONC |   |                          |   |   | PERIMETER                       |          |               |
| HEATING                       |       |    |      |   | NO PLUMBING              |   |   | L/F                             |          |               |
| OTHER FEATURES                |       |    |      |   | PERIM. AREA RATIO        |   |   | L/F                             |          |               |
| NO HEAT                       |       |    |      |   | PART MASONRY WALLS       |   |   | NO. OF UNITS                    |          |               |
| NO HEAT 2ND ONLY              |       |    |      |   | FIREPLACE (INGRADE)      |   |   | AVG. UNIT SIZE                  |          |               |
| WARM AIR F G                  |       |    |      |   | BSMT. RR/APT.            |   |   | BASEMENT SIZE                   |          |               |
| HW/STEAM BB RAD               |       |    |      |   | BSMT. GAR 1 2            |   |   | SCHEDULE                        |          |               |
| FLOOR/WALL FURNACE            |       |    |      |   | BUILT-IN RANGE/DW/DISP   |   |   | HT.                             |          |               |
| AIR CON./ELEC.                |       |    |      |   | MODERN KITCHEN           |   |   | BASEMENT                        |          |               |
| ATTIC                         |       |    |      |   | EXTERIOR BETTER          |   |   | FIRST                           |          |               |
| 1                             | 2     | 3  | 4    | 5 | INTERIOR BETTER          |   |   | SECOND                          |          |               |
| NONE UNFIN. 1/4 1/2 FULL      |       |    |      |   |                          |   |   | THIRD                           |          |               |
| ROOF                          |       |    |      |   | LIVING ACCOMMODATIONS    |   |   | BASE PRICE                      |          |               |
| SHINGLES ASP/ASB/WOOD         |       |    |      |   | NO. OF UNITS BED ROOMS   |   |   | B P A                           |          |               |
| SLATE/TILE/METAL              |       |    |      |   | TOTAL ROOMS FAMILY ROOMS |   |   | SUB TOTAL                       |          |               |
| ROLL/T & G                    |       |    |      |   | DWELLING COMPUTATIONS    |   |   | LIGHTING                        |          |               |
| EXTERIOR WALLS                |       |    |      |   | STORY F M                |   |   | HTG/AIR CON.                    |          |               |
| BEVEL/DROP/ALUM/VIN           |       |    |      |   | S.F.                     |   |   | SPRINKLER                       |          |               |
| SHINGLE ASPH/ASB/WOOD         |       |    |      |   | BASEMENT                 |   |   | PARTITIONS                      |          |               |
| CB/STUCCO/BRICK VENEER/STONE  |       |    |      |   | HEATING                  |   |   | INTERIOR FINISH                 |          |               |
| MASONITE/TI-II                |       |    |      |   | PLUMBING                 |   |   | SF/CF PRICE                     |          |               |
| PLATE GLASS - AL/WD           |       |    |      |   | ATTIC                    |   |   | AREA CUBED                      |          |               |
| FLOORS                        |       |    |      |   | INTERIOR FINISH          |   |   | SUB TOTAL                       |          |               |
| CONC/DIRT                     |       |    |      |   | ADD. & PORCHES           |   |   | M & O.F.                        |          |               |
| HARD WOOD                     |       |    |      |   |                          |   |   | ADDITIONS                       |          |               |
| SOFT WOOD/SUB                 |       |    |      |   |                          |   |   | TOTAL BASE                      |          |               |
| TILE                          |       |    |      |   |                          |   |   | GRADE FACTOR                    |          |               |
| W - W                         |       |    |      |   |                          |   |   | REPLACEMENT COST                |          |               |
| JOISTS                        |       |    |      |   |                          |   |   | FUNCTIONAL DEPRECIATION FACTORS |          |               |
| INTERIOR FINISH               |       |    |      |   | TOTAL                    |   |   | SURPLUS CAP                     |          |               |
| DRYWALL/PLASTER               |       |    |      |   | GRADE                    |   |   | ENCROACHMENTS                   |          |               |
| PANELING                      |       |    |      |   | TOTAL                    |   |   | BLIGHTED AREA                   |          |               |
| FIBERBOARD                    |       |    |      |   | O. F.                    |   |   | COMM. LOCATION                  |          |               |
| JNFINISHED                    |       |    |      |   | TOTAL                    |   |   | OVERBUILT                       |          |               |
| REMODELING DATA               |       |    |      |   | C & D FACTOR             |   |   | STRUCTURAL                      |          |               |
| KITCHEN                       |       |    |      |   |                          |   |   |                                 |          |               |
| PLUMBING                      |       |    |      |   |                          |   |   |                                 |          |               |
| HEAT                          |       |    |      |   |                          |   |   |                                 |          |               |
| BASEMENT                      |       |    |      |   |                          |   |   |                                 |          |               |
| OTHER                         |       |    |      |   |                          |   |   |                                 |          |               |
| REPL. COST                    |       |    |      |   |                          |   |   |                                 |          |               |

|              |  |  |  |  |  |  |  |  |  |
|--------------|--|--|--|--|--|--|--|--|--|
| O W T E      |  |  |  |  |  |  |  |  |  |
| CONTEMPORARY |  |  |  |  |  |  |  |  |  |
| SPLIT LEVEL  |  |  |  |  |  |  |  |  |  |
| RANCH (R)    |  |  |  |  |  |  |  |  |  |
| CAPE         |  |  |  |  |  |  |  |  |  |
| COLONIAL     |  |  |  |  |  |  |  |  |  |
| CONVENTIONAL |  |  |  |  |  |  |  |  |  |
| MEMORANDA    |  |  |  |  |  |  |  |  |  |

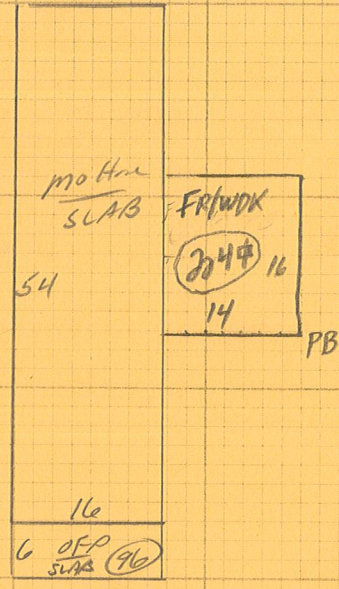

| TYPE     | LOC. | NO. | CONSTRUCTION        | SIZE   | RATE  | GRADE | ERECTED | CONDITION | REPLACEMENT COST | DEPR. | TRUE VALUE |
|----------|------|-----|---------------------|--------|-------|-------|---------|-----------|------------------|-------|------------|
| DWELLING |      |     |                     |        |       |       |         |           |                  |       |            |
| GARAGE   |      |     |                     |        |       |       |         |           |                  |       |            |
| BARN     |      |     |                     |        |       |       |         |           |                  |       |            |
| SHED     | ⊗    |     | 15 FR 8x10          | 80x    | 17.80 | C     | 2001    | C         | 1400             | 5/20  | 1060       |
|          |      |     | champion            | 116x58 |       | B     | 2001    | C         | 47600            | 10    | 42840      |
|          |      |     | Mo Home             | 96x    |       | D     | 2001    | C         | 2360             | 5/20  | 1740       |
|          |      |     | ATT OFP             | 96x    |       | C     | 2017    | C         | 4600             | 70    | 4176       |
|          |      |     | ATT FR/WDK          | 224x   |       |       |         |           |                  |       |            |
|          |      |     | COMMERCIAL BUILDING |        |       |       |         |           |                  |       |            |

|                           |         |
|---------------------------|---------|
| SUMMARY OF BUILDINGS      |         |
| LISTED                    | DATE    |
|                           | 9/23/00 |
| TOTAL CARDS               | THRU    |
|                           |         |
| TOTAL VALUE ALL BUILDINGS | 49816   |
|                           | 46040   |

CONDITION: 1-EXCELLENT; 2-GOOD; 3-AVERAGE; 4-FAIR; 5-POOR

DO NOT CONFUSE THE TWO

GRADE DENOTES QUALITY OF CONSTRUCTION: A-EXC.; B-GOOD; C-AVERAGE; D-CHEAP; E-VERY CHEAP  
DEPRECIATION FACTOR REFERS TO THE CONDITION, DESIRABILITY, USEFULNESS OF THE BUILDING.