

PROPERTY ASSESSMENT RECORD



| RECORD OF OWNERSHIP | DATE | BOOK | PAGE | AMOUNT |
|--|--------|-------|------|---------|
| Hill, C. David, Gilboy, John & Townsend, Julia | 9/9/21 | 18808 | 248 | 510,000 |
| | | | | |
| | | | | |
| | | | | |
| | | | | |
| | | | | |
| | | | | |
| | | | | |
| | | | | |
| | | | | |

LAND VALUE COMPUTATIONS AND SUMMARY

BUILDING PERMIT RECORD

PROPERTY FACTORS

| CLASSIFICATION | NO. OF ACRES | RATE | TOTAL |
|------------------------------|--------------|------------|--------------|
| TILLABLE | | | |
| PASTURE | | | |
| WOODLAND | 1.30 | 4000 | 5200 |
| WASTE LAND | 3.40 | 300 | 1020 |
| BASE | 1.0 | | 60000 |
| TOTAL ACREAGE | 5.70 | | |
| FRONTAGE | DEPTH | UNIT PRICE | DEPTH FACTOR |
| 425 | | | |
| BASE VAL-307. | | | 18000 |
| TOTAL VALUE LAND | | 48200 | 66200 |
| TOTAL VALUE BUILDINGS | | | 176500 |
| TOTAL VALUE LAND & BUILDINGS | | 48200 | 242700 |

| PERMIT NO. | EST. COST | DATE |
|--|-----------|------|
| MEMORANDA | | |
| 18 M ² NC, ~ 40% good, check 2019 | | |
| 19 Compl + deck + add Plumb | | |
| 21 Horse Barn + sled | | |

| TOPOGRAPHY | IMPROVEMENTS |
|---------------|---|
| LEVEL | WATER <input checked="" type="checkbox"/> Drilled <input checked="" type="checkbox"/> |
| HIGH | SEWER <input checked="" type="checkbox"/> Septic <input checked="" type="checkbox"/> |
| LOW | GAS |
| ROLLING | ELECTRICITY |
| SWAMPY | ALL UTILITIES |
| STREET | |
| PAVED | IMPROVING <input checked="" type="checkbox"/> |
| SEMI-IMPROVED | STATIC <input checked="" type="checkbox"/> |
| DIRT | DECLINING |
| SIDEWALK | BLIGHTED |

| CLASSIFICATION | NO. OF ACRES | RATE | TOTAL |
|------------------------------|--------------|------------|--------------|
| SOFTWOOD | | | 2021 |
| MIXED WOOD | | | |
| HARDWOOD | | | |
| WASTE LAND | | | |
| BASE | | | |
| TOTAL ACREAGE | | | |
| FRONTAGE | DEPTH | UNIT PRICE | DEPTH FACTOR |
| | | | |
| TOTAL VALUE LAND | | | 66,200 |
| TOTAL VALUE BUILDINGS | | | 200,200 |
| TOTAL VALUE LAND & BUILDINGS | | | 268,400 |

| INSPECTION WITNESSED BY: |
|--------------------------|
| |

| PROPERTY INFORMATION |
|----------------------|
| LAND COST |
| BLDG. COST |
| SALE PRICE |
| RENT |
| EXPENSE |
| NET RENT |
| LAND @ % equals |
| BLDG. @ % equals |
| TOTAL |

| ASSESSMENT RECORD | | | |
|-------------------|--------|----|--------|
| 20 | LAND | 20 | LAND |
| | BLDGS. | | BLDGS. |
| | TOTAL | | TOTAL |
| 20 | LAND | 20 | LAND |
| | BLDGS. | | BLDGS. |
| | TOTAL | | TOTAL |
| 20 | LAND | 20 | LAND |
| | BLDGS. | | BLDGS. |
| | TOTAL | | TOTAL |

| OCCUPANCY | | | | | PLUMBING | | | COMMERCIAL COMPUTATIONS | | |
|------------------------------|--------------|-------|-------|------------------|------------------------|---|---|---------------------------------|----------|---------------|
| 1 | 2 | 3 | 4 | | NO. | M | O | EXTERIOR WALL CODES | | |
| VAC. | LOT DWELLING | COMM. | OTHER | STANDARD | | | | 1 FRAME | 5 STUCCO | 9 CONCRETE |
| | | | | BATHROOM | | | | 2 BRICK | 6 TILE | 10 ENAM. STL. |
| | | | | TOILET ROOM | | | | 3 GLASS | 7 STONE | |
| | | | | SINK/LAVATORY/SS | | | | 4 C B | 8 METAL | |
| NONE | CRAWL | 1/4 | 1/2 | FULL | | | | | A | B |
| FOUNDATION | | | | | WATER CLOSET/URINAL | | | EXTERIOR WALLS | | |
| P | B & S | CB | CONC | Shower | | | | PERIMETER | | |
| HEATING | | | | | NO PLUMBING | | | PERIM. AREA RATIO | | |
| OTHER FEATURES | | | | | PART MASONRY WALLS | | | NO. OF UNITS | | |
| NO HEAT | | | | | FIREPLACE (IN-GRADE) | | | AVG. UNIT SIZE | | |
| NO HEAT 2ND ONLY | | | | | BSMT. RR/APT. | | | BASEMENT SIZE | | |
| WARM AIR F G | | | | | BSMT. GAR 1 ? | | | SCHEDULE | | |
| HW/STEAM BB RAD | | | | | BUILT-IN RANGE/DW/DISP | | | HT. | | |
| FLOOR/WALL FURNACE | | | | | MODERN KITCHEN | | | BASEMENT | | |
| AIR CON./ELEC. | | | | | EXTERIOR BETTER | | | FIRST | | |
| ATTIC | | | | | INTERIOR BETTER | | | SECOND | | |
| 1 | 2 | 3 | 4 | 5 | | | | THIRD | | |
| NONE | UNFIN. | 1/4 | 1/2 | FULL | | | | BASE PRICE | | |
| ROOF | | | | | LIVING ACCOMMODATIONS | | | B P A | | |
| SHINGLES ASP/ASB/WOOD | | | | | NO. OF UNITS 01 | | | SUB TOTAL | | |
| SLATE/TILE/METAL | | | | | TOTAL ROOMS | | | LIGHTING | | |
| ROLL/T & G | | | | | FAMILY ROOMS | | | HTG/AIR CON. | | |
| EXTERIOR WALLS | | | | | DWELLING COMPUTATIONS | | | SPRINKLER | | |
| BEVEL/DROP/ALUM/VIN | | | | | 2.0 STORY (F) M | | | PARTITIONS | | |
| SHINGLE ASPH/ASB/WOOD | | | | | 1608 S.F. 108100 | | | INTERIOR FINISH | | |
| CB/STUCCO/BRICK VENEER/STONE | | | | | BASEMENT | | | SF/CF PRICE | | |
| MASONITE/TI-II | | | | | HEATING P + 6160 | | | AREA CUBED | | |
| PLATE GLASS - AL/WD | | | | | PLUMBING + 4400 | | | SUB TOTAL | | |
| FLOORS | | | | | ATTIC | | | M & O.F. | | |
| B | 1 | 2 | 3 | A | INTERIOR FINISH | | | ADDITIONS | | |
| CONC/DIRT | | | | | ADD. & PORCHES + 14600 | | | TOTAL BASE | | |
| HARD WOOD | | | | | + 16,500 | | | GRADE FACTOR | | |
| SOFT WOOD/SUB | | | | | TOTAL 130,760 | | | REPLACEMENT COST | | |
| FILE | | | | | TOTAL 171585 | | | FUNCTIONAL DEPRECIATION FACTORS | | |
| W - W | | | | | TOTAL 176,500 | | | SURPLUS CAP | | |
| JOISTS | | | | | TOTAL 171585 | | | ENCROACHMENTS | | |
| INTERIOR FINISH | | | | | TOTAL 171585 | | | BLIGHTED AREA | | |
| B | 1 | 2 | 3 | A | TOTAL 176,500 | | | COMM. LOCATION | | |
| DRYWALL/PLASTER | | | | | TOTAL 176,500 | | | OVERBUILT | | |
| PANELING | | | | | TOTAL 176,500 | | | STRUCTURAL | | |
| FIBERBOARD | | | | | TOTAL 176,500 | | | | | |
| UNFINISHED | | | | | TOTAL 176,500 | | | | | |
| REMODELING DATA | | | | | | | | | | |
| KITCHEN | | | | | | | | | | |
| PLUMBING | | | | | | | | | | |
| HEAT | | | | | | | | | | |
| BASEMENT | | | | | | | | | | |
| OTHER | | | | | | | | | | |
| REPL. COST 171585 | | | | | | | | | | |

| SUMMARY OF BUILDINGS | | | | | | | | | | |
|---|--------|-----|--------------|------|------|-------|---------|-----------|------------------|--------------------|
| TYPE | LOC. | NO. | CONSTRUCTION | SIZE | RATE | GRADE | ERECTED | CONDITION | REPLACEMENT COST | DEPR. * TRUE VALUE |
| DWELLING | | | 2 1/2 FR | 1608 | | 1.35 | 2018 | G | 171585 | 60 68634 |
| GARAGE | | | | | | | | | 176,500 | - 176,500 |
| BARN | | | 1 1/2 FR | 860 | 24.5 | C | 2021 | G | 19,200 | - 19,200 |
| SHED | ATTICH | | 1 1/2 FR | 300 | | C | 2021 | G | 6,500 | - 6,500 |
| COMMERCIAL BUILDING | | | | | | | | | | |
| LISTED | | | | | | | | | | |
| DATE 8/27/18 | | | | | | | | | | |
| TOTAL VALUE ALL BUILDINGS 176,500 68634 207,200 | | | | | | | | | | |

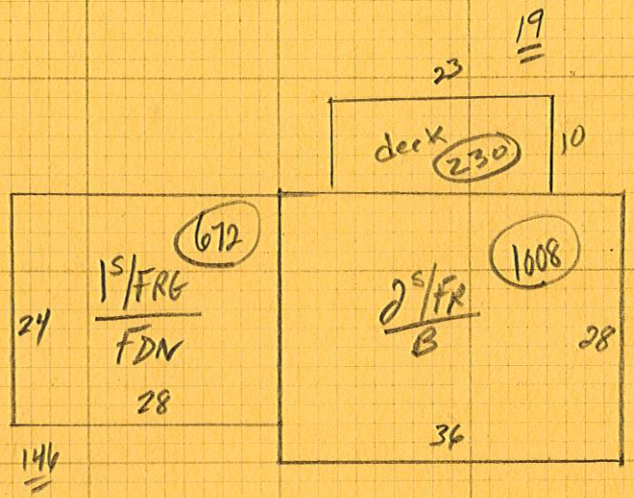

O W T E

CONTEMPORARY SPLIT LEVEL RANCH (R) CAPE COLONIAL CONVENTIONAL

MEMORANDA * Approx. 40% good for 2018.

(19) compl add deck

2021 horse barn + attached Roof